

Fort Hays State University

FHSU Scholars Repository

Sheridan Hall

Buildings & Facilities

June 1905

Sheridan Coliseum: Brochure, Sheridan Coliseum Campaign

Sheridan Coliseum Campaign Office

Follow this and additional works at: <https://scholars.fhsu.edu/sheridan>

Recommended Citation

Sheridan Coliseum Campaign Office, "Sheridan Coliseum: Brochure, Sheridan Coliseum Campaign" (1905). *Sheridan Hall*. 5.
<https://scholars.fhsu.edu/sheridan/5>

This Document is brought to you for free and open access by the Buildings & Facilities at FHSU Scholars Repository. It has been accepted for inclusion in Sheridan Hall by an authorized administrator of FHSU Scholars Repository.

S C H O L I S D A N C O L I S E U M



A program to preserve
a Kansas landmark which will
continue to serve
as an inspiration to
students and patrons
of the arts

FORT HAYS STATE UNIVERSITY
HAYS, KANSAS

FORT HAYS STATE UNIVERSITY

Leading the Sheridan Coliseum Campaign are (left to right): Gerald W. Tomanek, University President, Norbert R. Dreiling, and Robert E. Schmidt, Co-Chairmen of the Sheridan Coliseum Campaign.



Since its founding in 1902, Fort Hays State University has enjoyed a reputation of excellence in higher education throughout Kansas and the Midwest. The University takes great pride in its past accomplishments and it continually lays the groundwork for an even brighter future.

Today, Fort Hays State University has arrived at a pivotal point in its growth. For the University to maintain the quality of its student services and to remain at the forefront in cultural activities in Western Kansas, it must upgrade the quality of its existing physical facilities through renovation of present structures.

After extensive research and study, the Kansas Board of Regents has outlined a solution to the problem. The solution is to renovate Sheridan Coliseum — a

*We must provide
\$2,000,000 to
renovate Sheridan
Coliseum to provide
a performing arts
center for Fort Hays
State University.*

landmark structure in Western Kansas — and to convert it into a new Performing Arts/Student Services Center. In this way, not only will the University's need for additional, top quality physical facilities be answered, but also an important Kansas landmark, which has touched the lives of tens of thousands of people in the state, will be preserved for the benefit of future generations.

The cost of renovating Sheridan Coliseum has been estimated at \$6,000,000. In order to assure completion of this project, a \$2,000,000 campaign has been launched to raise private funds from businesses, foundations and interested citizens of Western Kansas, the state and nation. We urge you to join with us in support of the Sheridan Coliseum Campaign — your help in preserving the past will insure the future.

THE HERITAGE AND HISTORY



A view of the capacity crowd attending "Il Trovatore" — the first Grand Opera ever presented in Western Kansas — which was hosted on Sheridan Coliseum's opening night, March 23, 1917.



The above photo as well as the one at the bottom of this page reflect but two of the many activities held in the Coliseum in the past.

Established in 1902 to educate teachers for the rapidly developing High Plains of Western Kansas, Fort Hays State University began operations in an old, abandoned military post known as Fort Hays. During the University's first year, 19 students and two instructors comprised the student body and faculty.

In 1904, the college was moved to a new location near the City of Hays.

In 1914, the school's new President, William A. Lewis, brought Henry Edward Malloy from Bethany College in Lindsborg, Kansas, to head up the music department. Though he had only been President for a year at the time, Lewis envisioned the school becoming the cultural center of Western Kansas, and he felt Malloy's influence would be the key to make that vision come true.

Malloy's musical productions began to gather larger and larger followings outside the Hays area, and graduates from the school joined the teaching staffs around the

state, spreading the school's reputation for cultural and educational excellence from one corner of Kansas to the other.

Lewis' dream became reality in March of 1917 with the opening of the school's new Sheridan Coliseum — the largest facility of its kind in Western Kansas. The structure — named after a prominent military officer and former commander of the post, General Philip Sheridan — was funded by a legislative appropriation in 1915, and it was the only building funded by the legislature for any state school

that year. There were many people who doubted that the Coliseum would ever be filled, including legislators who were critical of the use of state funds to build such a large structure in the western part of the state. This skepticism disappeared immediately because the new coliseum over-flowed with people on opening night. In time, "standing-room-only" became commonplace at many activities in Sheridan Coliseum.

During Sheridan Coliseum's inaugural year, it hosted the first Grand Opera ever presented in Western Kansas, and two years later, the first of the nationally acclaimed Music Festivals was held there. Sheridan Coliseum has been a place of inspiration to area residents and students alike and has served as the intercollegiate basketball arena, gymnasium, auditorium, classroom facility, the community's civic auditorium, performing arts theater and horse show arena — to mention a few of its many past uses. The coliseum is full of fond memories for many people.



SHERIDAN COLISEUM

The New Performing Arts/Student Services Center



Shown on this page are two artist's concepts of the new auditorium in the renovated Coliseum, along with the floorplans.

Sheridan Coliseum, although badly deteriorated, is structurally sound. The renovation of the structure will transform it into a 1,200-seat performing arts auditorium completely surrounded by a more centralized student services facility and administrative offices.

The new Center will enable the University to meet its need for top quality physical facilities in order to maintain academic excellence, and it will help to keep Hays in the spotlight as the cultural and entertainment center for Western Kansas.

The University already makes a significant impact upon the local economy. More than 682 area residents are employed, either full or part-time, by the University. Its almost \$16 million annual payroll makes Fort Hays State one of the area's top employers. The University spends nearly \$7,000,000 each year for goods and services required to operate its physical facilities. The majority of these funds flow directly back into the area's economy. Leading economists estimate that expenditures of this magnitude will quadruple in their total impact upon an area's economy. In view of these facts, it is evident that Fort Hays State University is not only a major contributor to the educational and cultural quality of the people of Western Kansas, but also it is a major contributor to their economic well-being.

AN INVESTMENT IN THE FUTURE

Your gift will be an investment in the future for all people of Western Kansas. It is a sound investment that will provide \$3 in educational, cultural and entertainment facilities for each dollar contributed.

Your support may be shown in

the form of cash or a cash pledge, payable over a three to five-year tax period. It may also take the form of marketable securities, appreciated properties, charitable trusts, bequests or other such mechanisms which may offer significant tax advantages over a cash gift. You are urged to consult with your tax accountant, tax attorney or financial advisor to determine the most advantageous method of giving to fit your particular needs.

Named gift opportunities, offering you the means to honor a family or organization name or to memorialize the name of a deceased friend or loved one, are available through the Campaign. The following list is for your convenience in finding a designated gift commensurate with your desire and ability to give. The amounts shown do not necessarily reflect actual costs as they are based upon their visibility and importance to the overall project.

To Rename the Building..... \$1,000,000

- ① To Name the Performing Arts Auditorium..... 750,000
- ② Ticket Booth..... 50,000
- ③ Entrance Foyer..... 100,000
- ④ Main Lobby..... 250,000
- ⑤ Stage..... 100,000
- ⑥ Orchestra Pit..... 75,000
- ⑦ Green Room..... 50,000

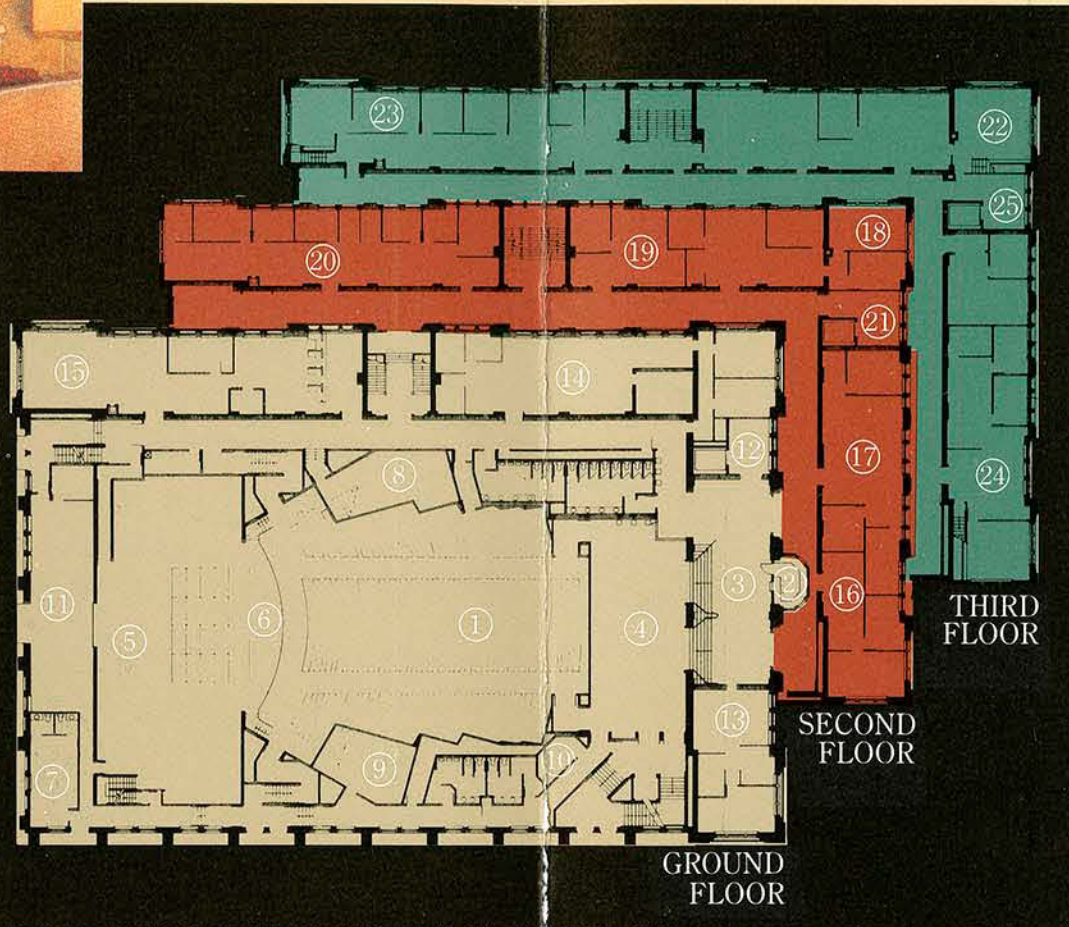

- Mezzanine..... 50,000
- ⑧ North Box Seats Area..... 125,000
- ⑨ South Box Seats Area..... 125,000
- Balcony..... 200,000
- ⑩ Technical Director's Office..... 10,000
- ⑪ Shop/Props Area..... 30,000
- Projection Room..... 20,000
- ⑫ Ground Floor Elevator Lobby..... 20,000
- ⑬ Admissions Counseling Office, complete..... 30,000
- Secretarial/Waiting Area .. 20,000
- Counselors' Office, (2).... 7,500
- Director's Office..... 10,000
- ⑭ Records Offices, complete .. 30,000

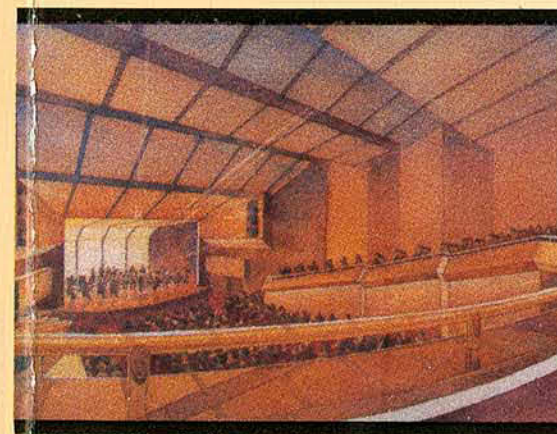

- Reception Area..... 15,000
- Transcripts File Area..... 5,000
- Records Storage Area..... 10,000
- Registrar's Office..... 10,000
- ⑮ Business Offices, complete..... 30,000
- Secretarial/Clerical Area .. 15,000
- Comptroller's Office..... 15,000
- Payroll and Accounting Area..... 10,000
- Vault..... 5,000

To Name the Student Services Center, entire second floor..... 500,000

- ⑯ Academic Affairs Offices, complete..... 30,000
- Secretarial/Waiting Area .. 20,000
- Vice President's Office .. 15,000
- Assistant to Vice President's Office..... 7,500
- ⑰ Graduate Studies Offices, complete..... 40,000
- Secretarial/Clerical/Waiting Area..... 20,000
- Dean's Office..... 15,000
- Continuing Education Dean's Office..... 10,000
- Continuing Education Office..... 5,000
- ⑱ Student Affairs Offices, complete..... 30,000
- Secretarial/Waiting Area .. 20,000
- Vice President's Office .. 15,000
- Associate Dean's Offices, (2)..... each 7,500
- International Student Office..... 5,000
- I.D. Photo Area..... 3,500
- ⑲ Housing Office, complete .. 20,000
- Secretarial/Waiting Area .. 15,000
- Housing Director's Office .. 7,500
- ⑳ Financial Aids and Career Planning Offices, complete..... 50,000
- Secretarial/Waiting Area .. 25,000
- Interview Rooms, (4)..... each 3,500

- Financial Aid Director's Office..... 7,500
- Assistant Director's Office .. 5,000
- Work/Study Coordinator's Office..... 5,000
- Career Planning Director's Office..... 7,500
- Counselor's Offices, (2)..... each 5,000
- Peer Counselor's Offices, (2)..... each 3,500
- Career Planning Library .. 15,000
- ㉑ Second Floor Elevator Lobby..... 20,000

To Name the Administrative Area, entire third floor..... 250,000

- ㉒ President's Office Suite, complete..... 75,000
- Secretarial/Waiting Area .. 20,000
- Affirmative Action Office.. 7,500
- Board Room..... 50,000
- President's Office..... 25,000
- ㉓ Administration and Finance Offices, complete..... 40,000
- Secretarial/Waiting Area .. 20,000
- Conference Room..... 15,000
- Budget Office..... 5,000
- Scheduling Office..... 5,000
- Testing Room..... 3,500
- Personnel Office..... 5,000
- Vice President's Office .. 15,000
- ㉔ Institutional Research, University Relations and Development Offices, complete..... 30,000
- Secretarial/Waiting Area .. 15,000
- Institutional Research Director's Office..... 10,000
- Waiting Secretarial Area .. 15,000
- Vice President's Office, University Relations and Development..... 15,000
- Publications Office..... 5,000
- Graphics Area..... 10,000
- Graphics Director's Office .. 5,000
- ㉕ Third Floor Elevator Lobby..... 20,000
- Dumbwaiter System..... 3,500
- Lighting and Landscaping .. 25,000

L E A D E R S H I P



Robert E. Schmidt
Co-chairman,
Campaign Council



Norbert R. Dreiling
Co-chairman,
Campaign Council



William C. Miller
Chairman,
Pattern Gifts Division



M. Dean Ellner
Chairman,
Advance Gifts Division



Harold L. Bittel
Chairman,
Special Gifts Division



Weir Pierson, M.D.
Chairman,
Trustee Gifts Division



Leland E. Bartholomew, Ph.D.
Chairman,
Faculty and Staff Gifts Division



Gerald W. Tomanek, Ph.D.
President,
Fort Hays State University



Dale B. Shade
President,
Endowment Association



Jerry Reed
President,
Alumni Association



Fred W. Berger
Vice Chairman,
Advance Gifts Division

Development Council Members:

(as of February 4, 1985)
Robert Albers, M.D.
Clair Anderson*
Francis R. Applegate, M.D.
Vinton K. Arnett, D.C.
Bill Aubel
Miriam Ball*
James H. Bartels*
Roger D. Batson
Mrs. Janelle Bedard
Fred W. Berger
Guy Bemis
Kenneth L. Beran, CPA
Donald G. Bickle*
Larry F. Bieker
John T. Bird Esq.
Elmer Bittel
Harold L. Bittel
Gary L. Boeve
Thomas C. Boone Esq.
Ron Bork
Norman W. Brandeberry
Kenneth R. Braun
Roy F. Brungardt
Richard Burnett*
Joe Butcher*
Alta Rutledge Butler
Earl Carlson, M.D.
David Carpenter
Gary D. Casey
Kenneth Clark Esq.
R. W. Collins

Robert M. Collins
Roger Comeau
Arden Cronn*
Robert Culley*
Ernest Deines Esq.*
Richard Diamond*
Al Dinges
Robert Dinges
Loren Doll
J. Murray Downing
Norbert R. Dreiling Esq.*
James R. Dreiling
Virginia Dreiling
Robert P. Dyck
Marcia Eads*
Norman Eaton*
Mike Eck
Victor M. Eddy, M.D.
William B. Elliott Esq.
M. Dean Ellner
Ralph N. Engel
Curtis C. Erickson*
Peter F. Felten, Jr.
Earl O. Field
Clayton S. Flood Esq.
Kenneth G. Folsom
Homer E. Foutz, DDS
Roger Franke*
Robert Fuller*
Lucille Gagelman*
Don Gamet*
Robert F. Glassman Esq.
Jack Goodman*

Edgar B. Grass
Peter M. Haas*
William J. Hall
Cliff Haltom
Gary Hanna*
Roberta Harkness*
Norvan Harris*
Nelson Hartman*
Van L. Hartman
Kenneth C. Havner Esq.*
Max Heim*
Robert Helman*
F. Jerald Hildreth*
Kenneth R. Hinkhouse
Mark R. Hook, DDS
Mearle Hoover*
James M. Hower
Ralph H. Hunter
Glen C. Hutchison, M.D.
Loren Janzen
Mike Johnson*
Toby Johnson
Dennis Keenan*
Tom C. Kelley Esq.
Bruce W. Kent Esq.
David M. King
James J. Kronewitter
Yvonne Krueger
Morris Krug
Mabel Lacey
Edward Larson Esq.
J. Michael Leas
Myron G. Lessman

Frank Lowman
Lloyd P. Lundy
William E. Lusk, Sr.
D. B. Mathews, DDS*
Katherine P. Mermis*
Paul W. Miller*
William C. Miller
John F. Mills
Mike Money*
Harlan F. Murphy
Don Nichol*
Jack R. Nicholson
Richard P. Nixon
Larry Noffsinger
Larry Nutting
Richard Ohmart, M.D.
Robert A. Pfeifer, CPA
Glen Pfortmiller
George Philip, V
Weir Pierson*
Lon E. Pishny
Robert D. Pokorny, DDS
Don E. Pratt
Jerry Reed*
Larry & Betty Reed*
Adolph A. Reisig*
Floyd Reynolds*
Frances E. Reynolds
William Robbins*
Richard Roemer*
Herbert A. Rogg
Carl Rohwer*

Darrel Rolph*
Melvin E. Romme
Terrance F. Rupp
Luecha Rutngamlug, M.D.
William H. Rymph
Olive Schafer
Robert J. Schibi
James A. Schiffelbein
Robert E. Schmidt
Vernon V. Schraeder
Robert E. Schumacher
Henry F. Schwaller, Sr.
Lois Scott*
Darrell G. Seibel
Dale B. Shade*
Mildred Sharp*
Paul Shepherd Esq.*
Tom Shook*
Gordon C. Simmons*
Gerald W. Tomanek*
David A. VanDoren
Kenneth D. Vehige
Fe T. Villarante, M.D.
George K. Vitztum, Jr.
Gerald J. Vitztum
Omer Voss*
Jan Weilert
Mrs. W. E. Wickizer
Bee Williams
J. D. Williams
Clair J. Wilson
Mary Woelk*
Dwight & Doris York

*Member, Endowment Association Board of Trustees

For additional information, contact:
Sheridan Coliseum Campaign Office
Fort Hays State University
600 Park Street, Box 272
Hays, Kansas 67601
913/628-5356