

Fort Hays State University

FHSU Scholars Repository

Buildings & Facilities

Campus History Collections

3-1-1979

Elevation and Floor Plans for Nursing Education Building

Fort Hays State University

Follow this and additional works at: <https://scholars.fhsu.edu/buildings>

Recommended Citation

Fort Hays State University, "Elevation and Floor Plans for Nursing Education Building" (1979). *Buildings & Facilities*. 1529.

<https://scholars.fhsu.edu/buildings/1529>

This Drawing is brought to you for free and open access by the Campus History Collections at FHSU Scholars Repository. It has been accepted for inclusion in Buildings & Facilities by an authorized administrator of FHSU Scholars Repository. For more information, please contact ScholarsRepository@fhsu.edu.

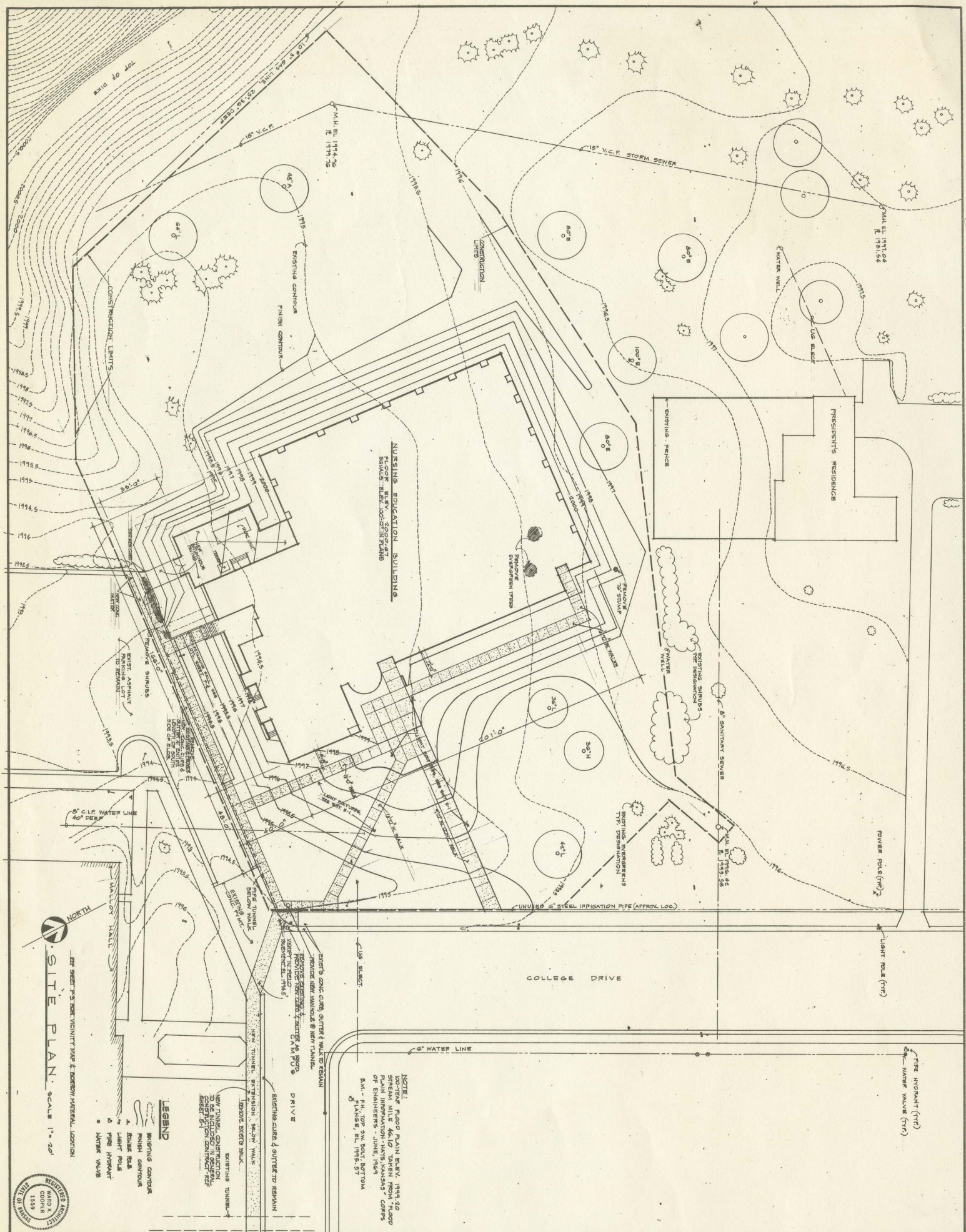

FORT HAYS STATE UNIVERSITY
HAYS, KANSAS

NURSING EDUCATION BUILDING

CCR NO. A-3321

HEW FED. NO.1-C05-NU-5004-01

DIVISION OF ARCHITECTURAL SERVICES
DIRECTOR
DEPARTMENT OF ADMINISTRATION
STATE OF KANSAS

PROJECT ARCHITECT

WILSON & COMPANY

SALINA

KANSAS

REVISION

DATE

BY

DESIGN
DATE
MAR. 1973
FILM NO.
18-000
SHEET NO.
P-1

MATERIAL DESIGNATIONS	
	CONCRETE
	BRICK
	INSULATION
	FLOOR FINISH
	WALL FINISH
	CEILING FINISH
	DOOR
	WINDOW
	STAIRS
	ROOF
	FOUNDATION
	MECHANICAL EQUIPMENT
	ELECTRICAL EQUIPMENT
	PLUMBING EQUIPMENT
	HEATING EQUIPMENT
	COOLING EQUIPMENT
	FIRE EQUIPMENT
	SECURITY EQUIPMENT
	COMMUNICATION EQUIPMENT
	TRANSPORTATION EQUIPMENT
	OTHER EQUIPMENT

SYMBOLS	
	BUILDING SECTION
	WALL SECTION
	FLOOR SECTION
	ROOF SECTION
	DOOR
	WINDOW
	STAIRS
	ROOF
	FOUNDATION
	MECHANICAL EQUIPMENT
	ELECTRICAL EQUIPMENT
	PLUMBING EQUIPMENT
	HEATING EQUIPMENT
	COOLING EQUIPMENT
	FIRE EQUIPMENT
	SECURITY EQUIPMENT
	COMMUNICATION EQUIPMENT
	TRANSPORTATION EQUIPMENT
	OTHER EQUIPMENT

NOTES	
1. ALL DIMENSIONS ARE TO FACE OF MEMBER OR TO FACE OF STRUCTURAL MEMBER.	
2. SEE DETAIL FOR CONSTRUCTION OF MEMBER OR TO FACE OF STRUCTURAL MEMBER.	
3. SEE DETAIL FOR CONSTRUCTION OF MEMBER OR TO FACE OF STRUCTURAL MEMBER.	
4. SEE DETAIL FOR CONSTRUCTION OF MEMBER OR TO FACE OF STRUCTURAL MEMBER.	
5. SEE DETAIL FOR CONSTRUCTION OF MEMBER OR TO FACE OF STRUCTURAL MEMBER.	
6. SEE DETAIL FOR CONSTRUCTION OF MEMBER OR TO FACE OF STRUCTURAL MEMBER.	
7. SEE DETAIL FOR CONSTRUCTION OF MEMBER OR TO FACE OF STRUCTURAL MEMBER.	
8. SEE DETAIL FOR CONSTRUCTION OF MEMBER OR TO FACE OF STRUCTURAL MEMBER.	
9. SEE DETAIL FOR CONSTRUCTION OF MEMBER OR TO FACE OF STRUCTURAL MEMBER.	
10. SEE DETAIL FOR CONSTRUCTION OF MEMBER OR TO FACE OF STRUCTURAL MEMBER.	

MAIN FLOOR PLAN	
SCALE: 1/8" = 1'-0"	
NORTH	

NOTES	
1. ALL DIMENSIONS ARE TO FACE OF MEMBER OR TO FACE OF STRUCTURAL MEMBER.	
2. SEE DETAIL FOR CONSTRUCTION OF MEMBER OR TO FACE OF STRUCTURAL MEMBER.	
3. SEE DETAIL FOR CONSTRUCTION OF MEMBER OR TO FACE OF STRUCTURAL MEMBER.	
4. SEE DETAIL FOR CONSTRUCTION OF MEMBER OR TO FACE OF STRUCTURAL MEMBER.	
5. SEE DETAIL FOR CONSTRUCTION OF MEMBER OR TO FACE OF STRUCTURAL MEMBER.	
6. SEE DETAIL FOR CONSTRUCTION OF MEMBER OR TO FACE OF STRUCTURAL MEMBER.	
7. SEE DETAIL FOR CONSTRUCTION OF MEMBER OR TO FACE OF STRUCTURAL MEMBER.	
8. SEE DETAIL FOR CONSTRUCTION OF MEMBER OR TO FACE OF STRUCTURAL MEMBER.	
9. SEE DETAIL FOR CONSTRUCTION OF MEMBER OR TO FACE OF STRUCTURAL MEMBER.	
10. SEE DETAIL FOR CONSTRUCTION OF MEMBER OR TO FACE OF STRUCTURAL MEMBER.	

NOTES	
1. ALL DIMENSIONS ARE TO FACE OF MEMBER OR TO FACE OF STRUCTURAL MEMBER.	
2. SEE DETAIL FOR CONSTRUCTION OF MEMBER OR TO FACE OF STRUCTURAL MEMBER.	
3. SEE DETAIL FOR CONSTRUCTION OF MEMBER OR TO FACE OF STRUCTURAL MEMBER.	
4. SEE DETAIL FOR CONSTRUCTION OF MEMBER OR TO FACE OF STRUCTURAL MEMBER.	
5. SEE DETAIL FOR CONSTRUCTION OF MEMBER OR TO FACE OF STRUCTURAL MEMBER.	
6. SEE DETAIL FOR CONSTRUCTION OF MEMBER OR TO FACE OF STRUCTURAL MEMBER.	
7. SEE DETAIL FOR CONSTRUCTION OF MEMBER OR TO FACE OF STRUCTURAL MEMBER.	
8. SEE DETAIL FOR CONSTRUCTION OF MEMBER OR TO FACE OF STRUCTURAL MEMBER.	
9. SEE DETAIL FOR CONSTRUCTION OF MEMBER OR TO FACE OF STRUCTURAL MEMBER.	
10. SEE DETAIL FOR CONSTRUCTION OF MEMBER OR TO FACE OF STRUCTURAL MEMBER.	

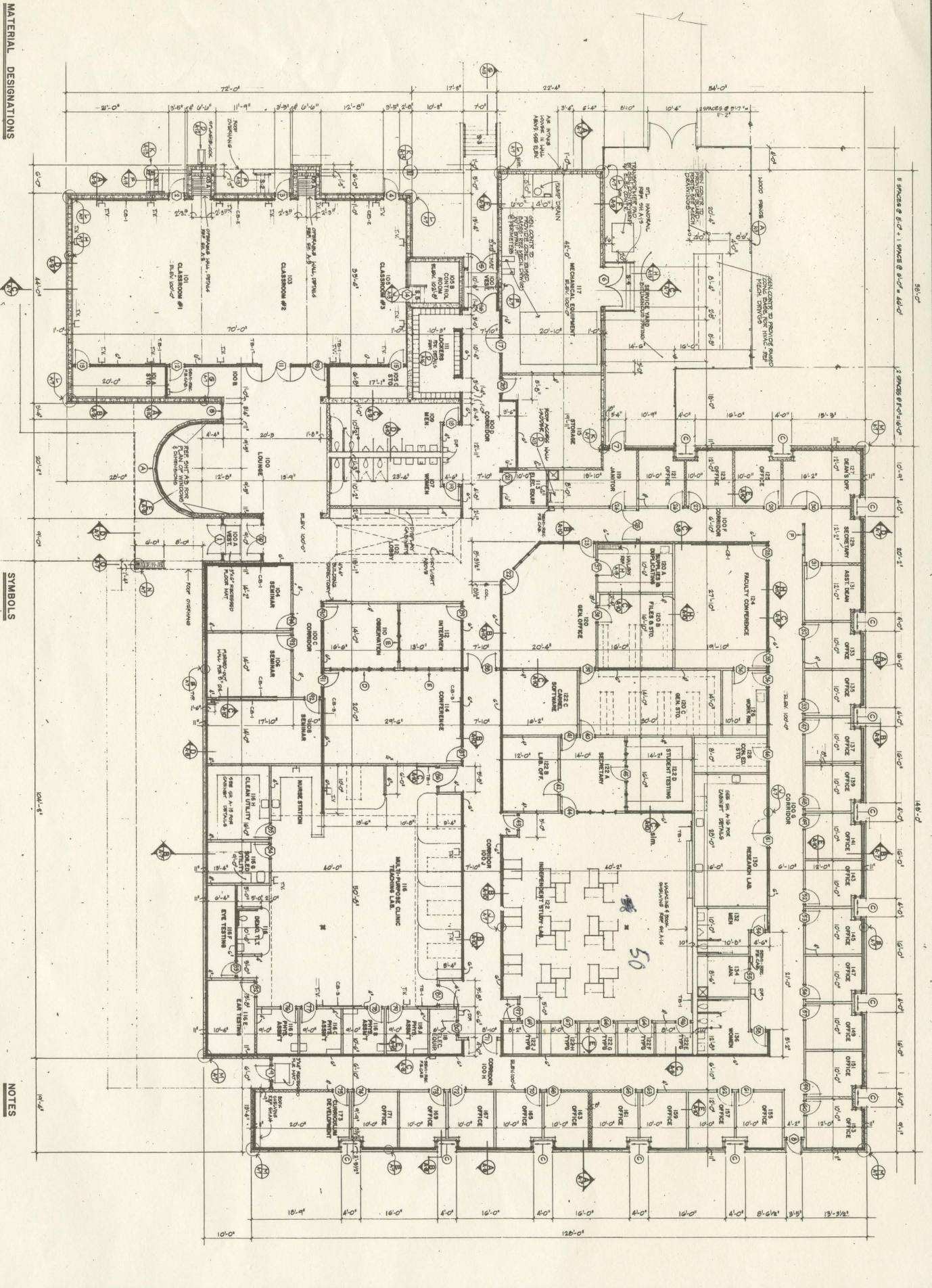

FORT HAYS STATE UNIVERSITY HAYS, KANSAS		NURSING EDUCATION BUILDING		CCR NO. A-3321 HEW FED. NO. 1-C05-NU-5004-01	
DIVISION OF ARCHITECTURAL SERVICES DIRECTOR DEPARTMENT OF ADMINISTRATION STATE OF KANSAS		PROJECT ARCHITECT WILSON & COMPANY SALINA KANSAS		REVISION	
DESIGN BY DATE FILE NO. 14-000 SHEET NO. A-1		DATE BY			